



DAS HERZ DER FRISCHE

VISITOR INFORMATION

FOR THE SINDELFINGEN SITE

VISITOR INFORMATION

WELCOME

We are delighted to welcome you to the Sindelfingen site. This flyer provides you with some useful information which will help you and us to make your visit as pleasant and, more importantly, as safe as possible. If you have any questions, please talk to your contact person, who will be glad to help you.

EMERGENCY

In the unlikely event of an emergency, the main thing is to keep calm. You can use the following telephone numbers to request prompt assistance internally at any time.

FIRE BRIGADE: 0-112

AMBULANCE: 0-112

POLICE: 0-112

WELCOME TO BITZER



BITZER Kühlmaschinenbau GmbH

Peter-Schaufler-Platz 1

71065 Sindelfingen // Germany

Tel +49 7031 932-0 // Fax +49 7031 932-147

bitzer@bitzer.de // www.bitzer.de

Subject to change // 80006701 // 08.2019

AF-100-2 EN

YOUR SAFETY IS VERY IMPORTANT TO US

All visitors must wear a **visitor ID** clearly displayed at all times while on company grounds. Our reception staff will provide you with visitor IDs when you enter the building. Please **return** your visitor ID there at the end of your visit.

Taking photos and filming are strictly prohibited on company premises. If it is necessary to take photos, you must obtain prior permission.

Please pay attention to prohibition signs!

Alcohol, smoking and intoxicant ban: No alcohol or intoxicants may be brought onto or consumed on the premises. Smoking is only permitted in the designated area.

Non-disclosure: Visitors and business partners are obliged to treat all trade and company secrets and other information to which they gain access as confidential.

German road traffic regulations apply on company premises. The **maximum speed** throughout the company premises is **ten kilometres per hour**. Parking is only permitted in the **car parks indicated**. The **'No stopping or parking' signs** must be strictly observed.

The buildings are fitted with **fire alarm systems**. In the event of fire, please remain calm. The first thing you should do is report the fire to the **fire brigade on 0-112**. Then warn others and bring yourself and other persons in danger **to safety along the marked escape routes**. If the situation allows it, **try to extinguish the fire** using the fire extinguishers provided. After leaving the building, go to the **assembly points**.

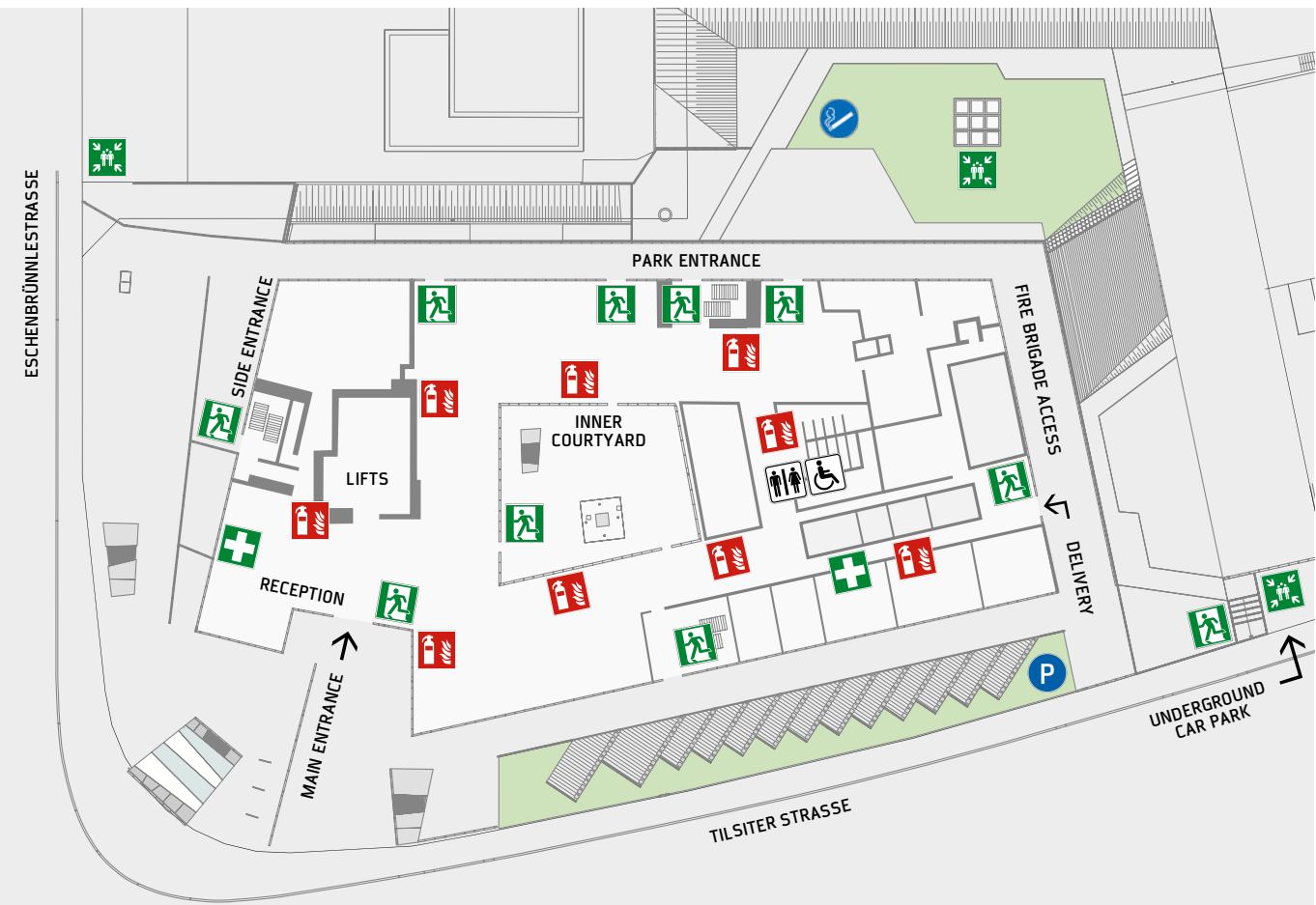

- EMERGENCY EXIT
- ASSEMBLY POINT
- SMOKING SHELTER
- CAR PARK
- FIRST AID
- WC
- ACCESSIBLE WC
- FIRE EXTINGUISHER

